

SCREENING CROSS SECTION 7

SCALE: H: 1"=50'
V: 1"=50'

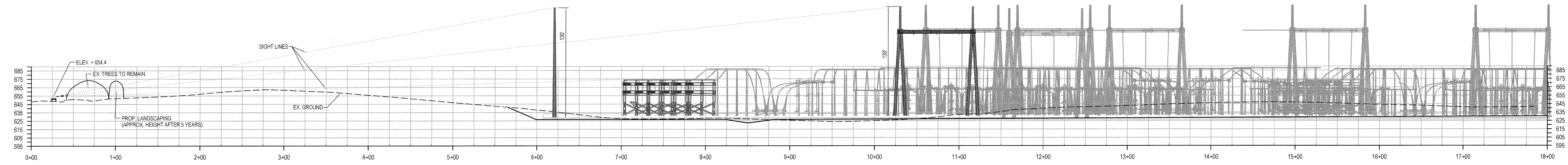

SCREENING CROSS SECTION 8

SCALE: H: 1"=50'
V: 1"=50'

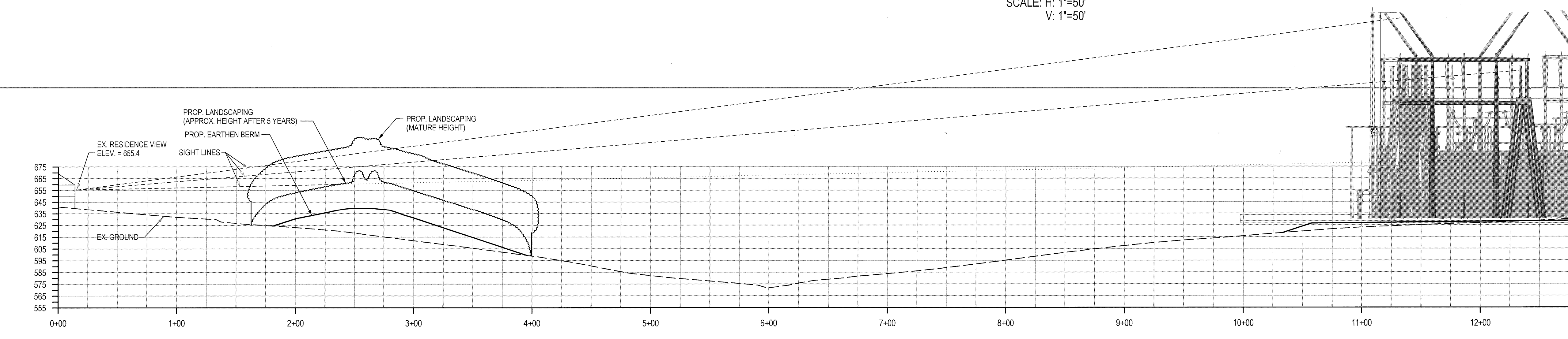

SCREENING CROSS SECTION 9

SCALE: H: 1"=50'
V: 1"=50'

MATCHLINE
SEE THIS SHEET

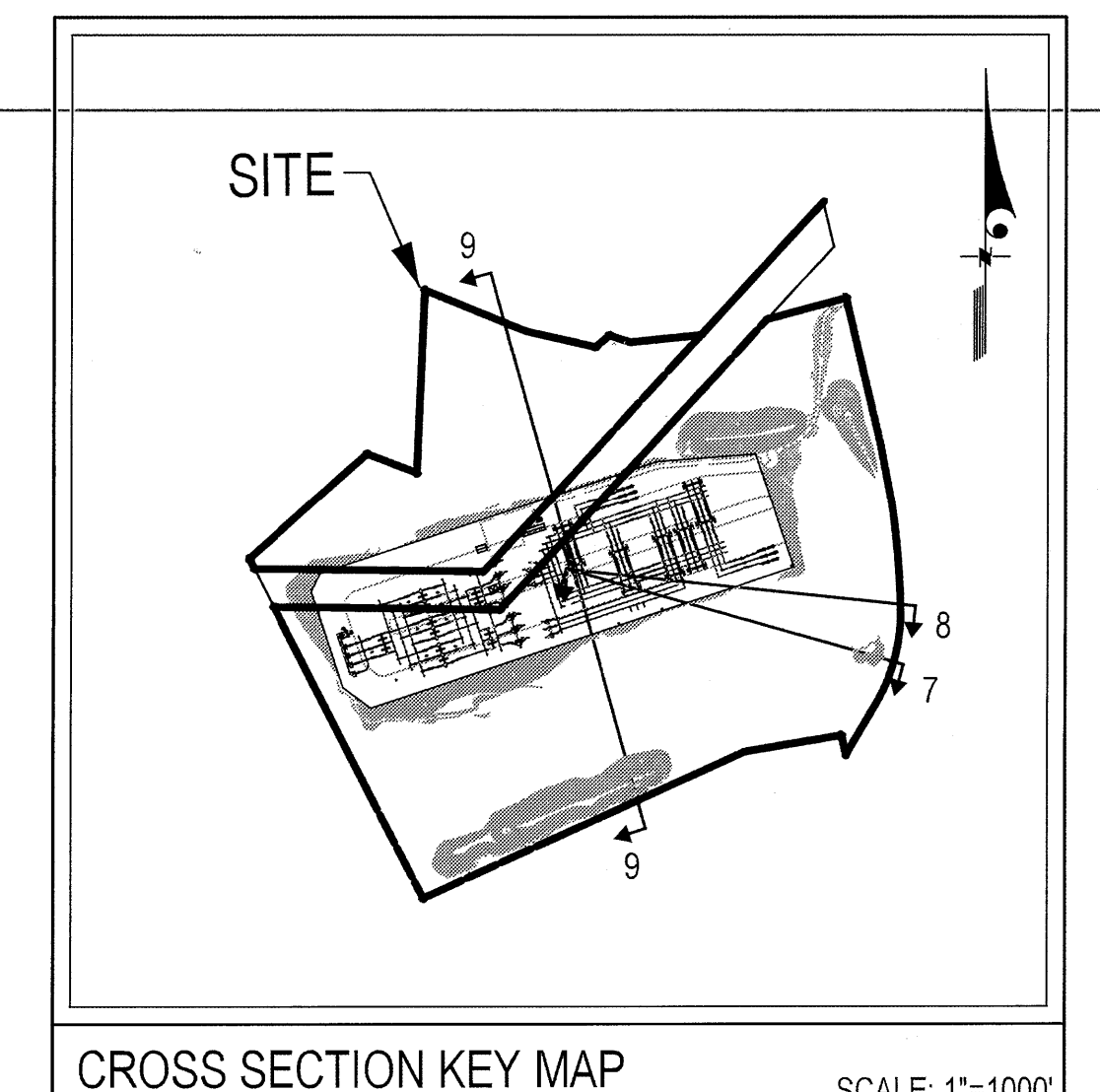

MATCHLINE
SEE THIS SHEET

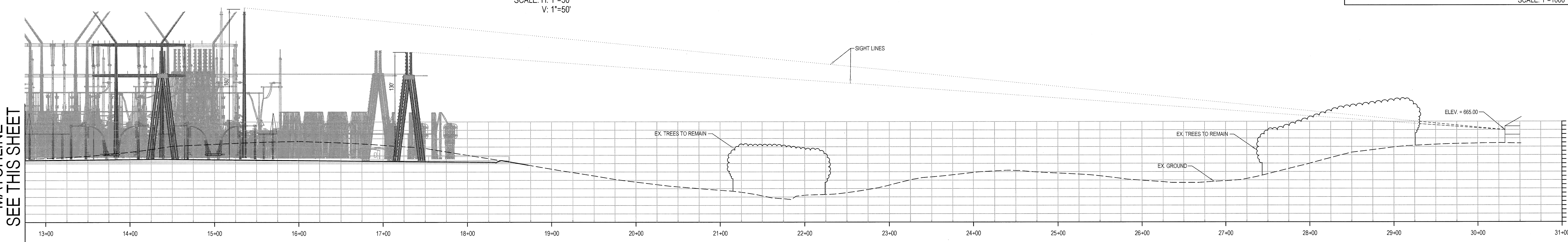

SCREENING CROSS SECTION 9 (CONT.)

SCALE: H: 1"=50'
V: 1"=50'



LS Loideman Soltesz Associates, Inc.
 2 Research Place, Suite 100
 Rockville, MD 20850
 t. 301.948.2750 f. 301.948.9067
 www.LSAssociates.net

Rockville
Lanham
Waldorf
Leonardtown

| NO. | DATE | REVISIONS | BY | DATE |
|-----|-------------|-----------|--------|------|
| 1 | AUGUST 2010 | DESIGNED | G.P. | |
| 2 | | TECHNICAL | G.M.M. | |
| 3 | | CHECKED | K.C.R. | |

MISS UTILITY NOTE
 INFORMATION CONCERNING EXISTING UNDERGROUND UTILITIES WAS OBTAINED FROM AVAILABLE RECORDS. THE CONTRACTOR MUST DETERMINE THE EXACT LOCATION AND DEPTH OF ALL EXISTING UTILITIES AND UTILITY CROSSINGS BY DIGGING TEST PITS BY HAND WELL IN ADVANCE OF THE START OF EXCAVATION. CONTACT "MISS UTILITY" AT 1-800-857-7777 48 HOURS PRIOR TO THE START OF EXCAVATION. IF CLEARANCES ARE LESS THAN SHOWN ON THIS PLAN OR TWELVE (12) INCHES, WHICHEVER IS LESS, CONTACT THE ENGINEER AND THE UTILITY COMPANY BEFORE PROCEEDING WITH CONSTRUCTION. CLEARANCES LESS THAN NOTED MAY REQUIRE REVISIONS TO THIS PLAN.

PREPARED FOR:
 KENNY CONSTRUCTION COMPANY
 12915 CONNOR DRIVE
 SUITE #204 / SUITE #205
 HAGERSTOWN, MARYLAND 21742
 PHONE: 301-745-9985
 FAX: 301-745-9636
 ATTN: MR. ROBERT DAHLIN

| | |
|--|---------------------|
| COPYRIGHT AND THE MAP PROPS. PRINTED USE NUMBER 081118 | |
| MAP 4689 | GRID C3, C4, D3, D4 |
| TAX MAP 89 | ZONING CATEGORY 'A' |
| MISSC 200 SHEET | |
| SITE DATUM | |
| HORIZONTAL: NAD 83/98 | |
| VERTICAL: NAD 83 | |

LANDSCAPE SCREENING CROSS SECTIONS - 3

KEMPTOWN SUBSTATION

SITUATED AT THE INTERSECTION OF BARTHOLOWS ROAD
AND WEST OAK DRIVE
NEW MARKET ELECTION DISTRICT No. 9
FREDERICK COUNTY, MARYLAND

SHEET **22**
OF **23**

PROJECT NO.
1814-00-00

The original of this drawing document was prepared by Loideman Soltesz Associates, Inc. (LSA). If this document was not obtained directly from LSA, and/or it was transmitted electronically, LSA cannot guarantee that unauthorized changes and/or alterations were not made by others. If verification of the information contained herein is needed, contact should be made directly with LSA. LSA makes no warranty, express or implied, concerning the accuracy of any information that has been transmitted by electronic means.